

# TRABUCO HILLS HIGH SCHOOL INSTRUMENTAL MUSIC PROGRAM

Brad Pollock  
Director of Instrumental Music

27501 Mustang Run  
Mission Viejo, CA 92691

(949) 768-1934  
<http://thhsmusic.com>

**Saturday, March 2, 2024**  
**2024 Southern California Essentially Ellington Regional Festival**  
**@ RCC Coil School for the Arts, Riverside City College (RCC)**  
**in Riverside, California (SCSBOA)**

## ITINERARY

TIME	EVENT
6:15 AM	Report time at Trabuco Hills High School
6:30 AM	Load Equipment & Cars
6:45 AM	Depart from Trabuco Hills High School
8:00 AM	Arrive at Riverside City College Unload & Use Restrooms
8:30 AM	Warm-Up
<b>9:00 AM</b>	<b>Trabuco Hills High School Jazz Ensemble Performance &amp; Clinic</b>
10:00 AM	Load Equipment
10:30 AM	Watch El Dorado High School #2
11:00 AM	Watch Esperanza High School #3
11:30 AM	Lunch ( <i>bring your own lunch</i> )
12:00 PM	Watch California Baptist University Jazz Ensemble
1:00 PM	Master Classes & Workshops
1:30 PM	Depart from Riverside City College
2:30 PM	Approximate Arrival at Trabuco Hills High School Unload and Dismissal

**\*\*\* Please keep in mind, no schedule is sacred and always subject to change!!!**

### REMINDERS

- All SVUSD and Music Program expectations and policies apply while traveling to/from and at the show site.



Last Updated on 2/26/2024 at 9:35 AM

**Thundering Mustangs Marching Unit \* Color Guard \* Percussion Ensemble \* Jazz Ensembles**  
**Symphony Orchestra \* Electric Strings \* Wind Ensemble \* Symphonic Band \* Pep Band**

<b>Friday, March 1st</b>		
<b>Time</b>	<b>Ensemble</b>	<b>Clinicians</b>
8:30 AM	Ramona High School	Fidyk/Watson
9:00 AM	Alta Loma High School #2	Stoll/Clayton
9:30 AM	Murrieta Valley High School	Fidyk/Watson
10:00 AM	Rancho Verde High School	Stoll/Clayton
10:30 AM	Alta Loma High School #1	Fidyk/Watson
11:00 AM	Yorba Linda HS	Stoll/Clayton
11:30 AM	<b>Lunch Break</b>	
12:00 PM	<b>RCC Jazz Ensemble</b>	
1:00 PM	<b>Masterclasses/Director Workshop</b>	
2:30 PM	Central Union High School	Fidyk/Watson
3:00 PM	Westlake High School	Stoll/Clayton
3:30 PM	El Camino Real Charter HS	Fidyk/Watson
4:00 PM	Newbury Park HS	Stoll/Clayton
4:30 PM	<b>Judges Break</b>	
5:00 PM	Bolsa Grande High School	Fidyk/Watson
5:30 PM	Tesoro High School	Stoll/Clayton
6:00 PM	Whittier Christian High School	Fidyk/Watson
6:30 PM	Aliso Niguel High School	Stoll/Clayton
7:00 PM	<b>RCC Jazz Orchestra</b>	
<b>Saturday, March 2nd</b>		
<b>Time</b>	<b>Ensemble</b>	<b>Clinicians</b>
8:30 AM	Santiago HS #2	Stoll/Clayton
9:00 AM	Trabuco Hills High School	Fidyk/Watson
9:30 AM	El Toro HS	Stoll/Clayton
10:00 AM	Katella High School	Fidyk/Watson
10:30 AM	El Dorado High School #2	Stoll/Clayton
11:00 AM	Esperanza HS #3	Fidyk/Watson
11:30 AM	<b>Lunch Break</b>	
12:00 PM	<b>Cal Baptist University Jazz Ensemble</b>	
1:00 PM	<b>Masterclasses/Director Workshop</b>	
2:30 PM	Orange County School of the Arts #3	Stoll/Clayton
3:00 PM	Santiago HS #1	Fidyk/Watson
3:30 PM	Esperanza HS #2	Stoll/Clayton
4:00 PM	Orange County School of the Arts #2	Fidyk/Watson
4:30 PM	<b>Judges Break</b>	
5:00 PM	Calabasas High School	Stoll/Clayton
5:30 PM	El Dorado High School #1	Fidyk/Watson
6:00 PM	Orange County School of the Arts #1	Stoll/Clayton
6:30 PM	Esperanza HS #1	Fidyk/Watson
7:00 PM	<b>RCC Jazz Orchestra</b>	



**ESSENTIALLY  
ELLINGTON**

Southern California Regional Jazz Festival  
March 1st and 2nd  
Riverside City College

<b>Masterclass Schedule 1:00-1:50</b>		
John Clayton	Rhythm Section Masterclass	Concert Hall Stage
Bijon Watson	Brass Masterclass	Choral Hall
Steve Fidyk	Drumset Masterclass	Rickson Band Hall
Todd Stoll and Lisa Linde	Band Director's Workshop	Classroom, CSA 250
Dan St. Marseille	Saxophone Masterclass	Classroom, CSA 251

<b>Masterclass Schedule 1:00-1:50</b>		
John Clayton	Rhythm Section Masterclass	Concert Hall Stage
Bijon Watson	Brass Masterclass	Choral Hall
Steve Fidyk	Drumset Masterclass	Rickson Band Hall
Todd Stoll and Lisa Linde	Band Director's Workshop	Classroom, CSA 250
Dan St. Marseille	Saxophone Masterclass	Classroom, CSA 251

Essentially Ellington So Cal Regional Festival  
RCC Coil School for the Arts  
3890 University Avenue  
Riverside, CA 92501

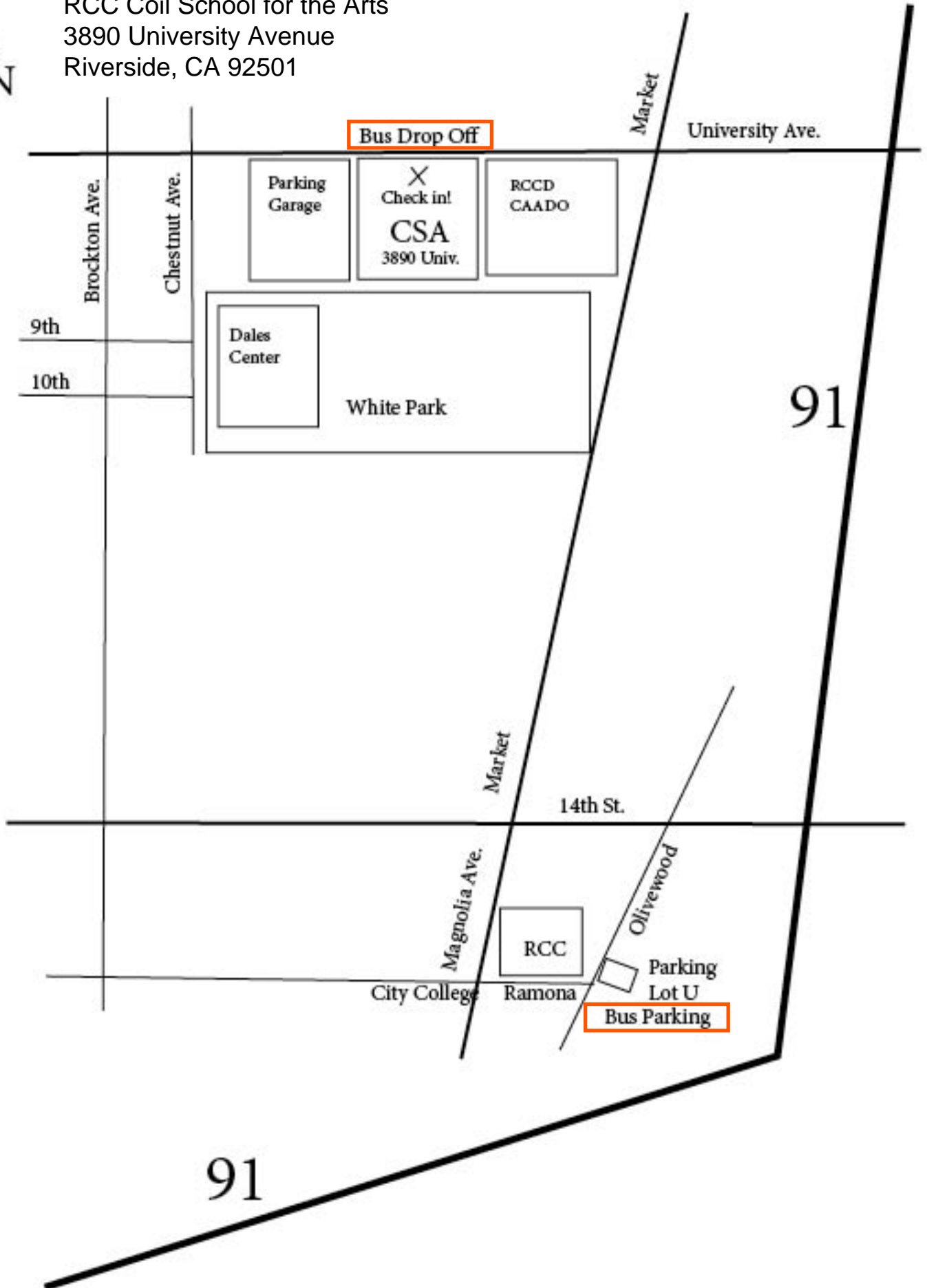

# 2024 Essentially Ellington So Cal Regional Festival Bus Parking in RCC Main Campus - Lot U Southeast Corner of Campus City College Drive and Olivewood Ave.

- Restrooms
- Accessible Restrooms
- ◆ Elevators
- ▨ Accessible
- 🚌 RTA Bus Lines
- 🚲 Bike Racks
- \$ Pay Parking
- ☎ Emergency Telephones
- Free Speech Area
- Healing Garden

- UPPER CAMPUS**
1. Digital Library & Learning Resource Center
  - Academic Senate/CTA
  - Auditorium
  - Glenn Hunt Center for Teaching Excellence
  - Instructional Media Center
  2. Administration (O.W. Noble)
  - Section A
    - Board Room
    - Disabled Services
    - H.O.M.E. Room (The Ujima Project)
    - Learning Disabilities Center
    - Mailroom/Admin Service Center
    - Veterans' Resource Center
    - Veterans' Services
  - Section B
    - Academic Affairs
    - Athletics
    - Business Services
    - Community Learning in Partnership (CLIP)
    - President's Office
    - Workforce Resource and Development
  3. Quadrangle (Arthur G. Paul)
  - Art Gallery
  - Community for Academic Progress (CAP)
  4. Business Education (Alan D. Pauw)
  - CalWORKS/Resource Center
  - Independent Living Program (ILP)
  - Micro Support Services
  - Workforce Preparation (WFP)
  5. Music
  - 5A. Music Annex
  6. Music Hall (Richard M. Stover)
  7. Landis Performing Arts Center
  - 7A. Landis Annex
  8. Martin Luther King, Jr. High Tech Center
  - Academic Labs
  - Center for Communication Excellence
  - Stem Center
  - Tutorial Services
  9. Assessment Center
  - Viewpoints
  10. Planetarium (Robert T. Dixon)
  11. School of Nursing
  - Healing Garden
  12. Math and Science Building
  13. Student Center (Ralph H. Bradshaw)
  - Aguilar Patio
  - Auxiliary Business Services/Cashier
  - Bookstore
  - Cafeteria/Food Services
  - Citrus Room
  - Extended Opportunities Programs & Services (E.O.P.S.)
  - Hall of Fame
  - Health Services
  - Heritage Room
  - Matriculation
  - Student Services/Student Activities
  - TRIO
  - Upward Bound
  - 13A. ASRCC Student Government
  - 13B. Information Services Telecom Annex
  14. Student Financial Services
  - Financial Aid
  - Network Services
  - Outreach Completion Counts Welcome Center
  - Student Employment Services
  15. Admissions & Counseling (Cesar E. Chavez)
  - Admissions & Records
  - Career/Transfer
  - Counseling
  - Transcripts
  - 15A. Annex/Wells Fargo
- LOWER CAMPUS**
16. Sports Complex (Samuel C. Evans)
  - Baseball Field
  - Pony League Field (Nate DeFrancisco)
  - Softball Field (Ab Brown)
  17. Early Childhood Studies
  18. Ceramics
  19. Art
  20. Gymnasium (Arthur N. Wheelock)
  - Athletics/Coaches' Office
  - Fitness Room
  21. Stadium (Arthur N. Wheelock Field)
  - Weight Room
  22. Nature Trail (Ariene & Robert F. Richard)
  23. North Hall
  - Finance & Accounting Services
  - Purchasing & Accounts Payable
  24. College House
  - Administration & Finance
  - Risk Management
  25. Riverside Aquatics Complex
  26. Technology B
  - Information Services
  - International Students Center
  - Printing & Graphics Center
  27. Technology A
  - Air Conditioning & Refrigeration
  - Career/Technical Education
  - Welding
  28. Automotive Technology
  - Lovekin Complex
  - College Safety and Police
  - Gateway to College (GTC)
  - Marching Tigers
  - Photo Lab & Studio
  - Tennis
  - Tennis Courts (Fran Bushman)
  30. Gymnasium (Catherine S. Huntley)
  - Band
  - Dance
  31. Pilates Studio (Eleanor H. Crabtree)
  32. Warehouse
  33. Maintenance & Operations
  34. Cosmetology
  35. Alumni House - 3564 Ramona Drive
  - Foundation
  36. Parking Structure
  37. Practice Field

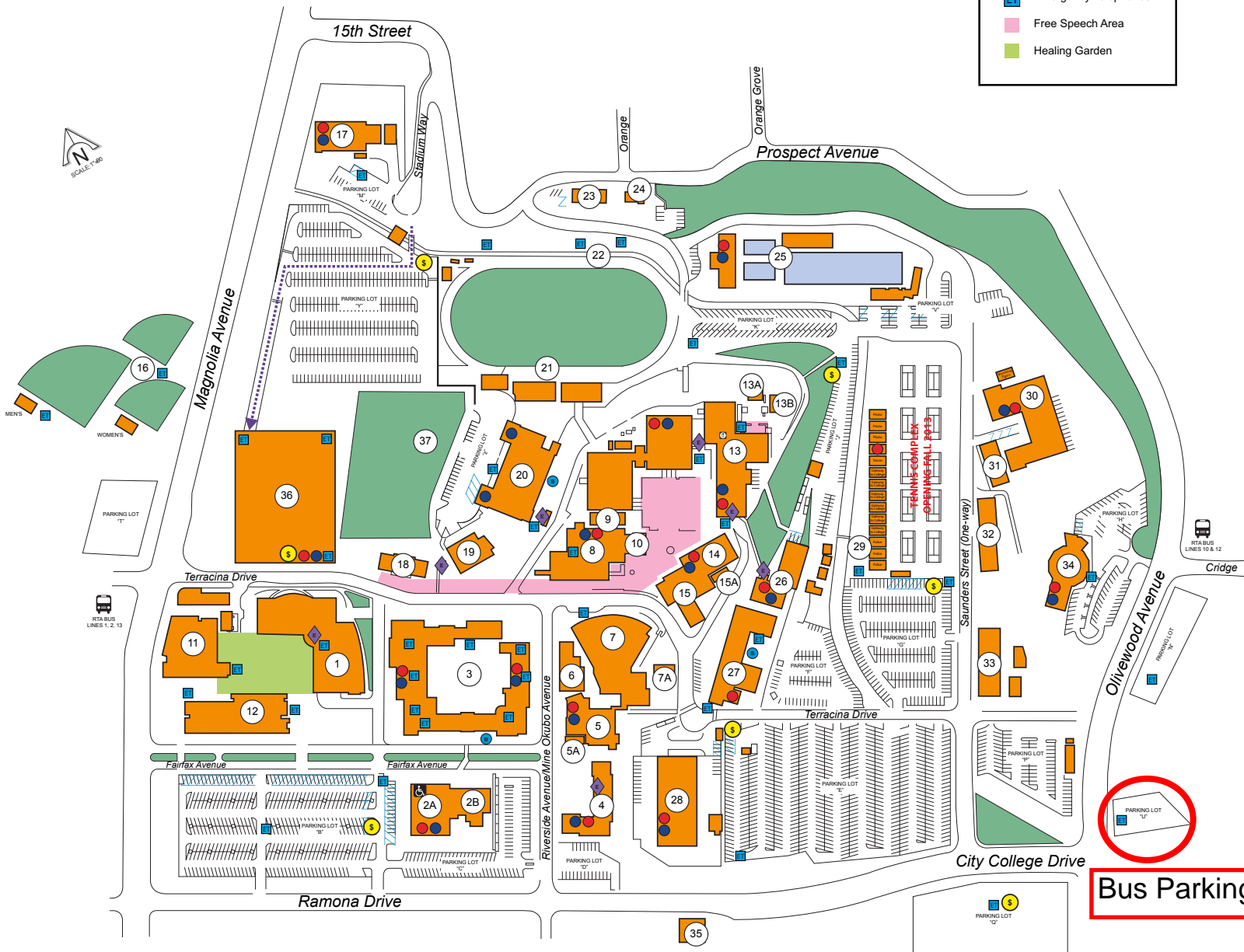

**Bus Parking**

# HENRY W. COIL SR & ALICE EDNA COIL SCHOOL FOR THE ARTS

## 1st Floor map

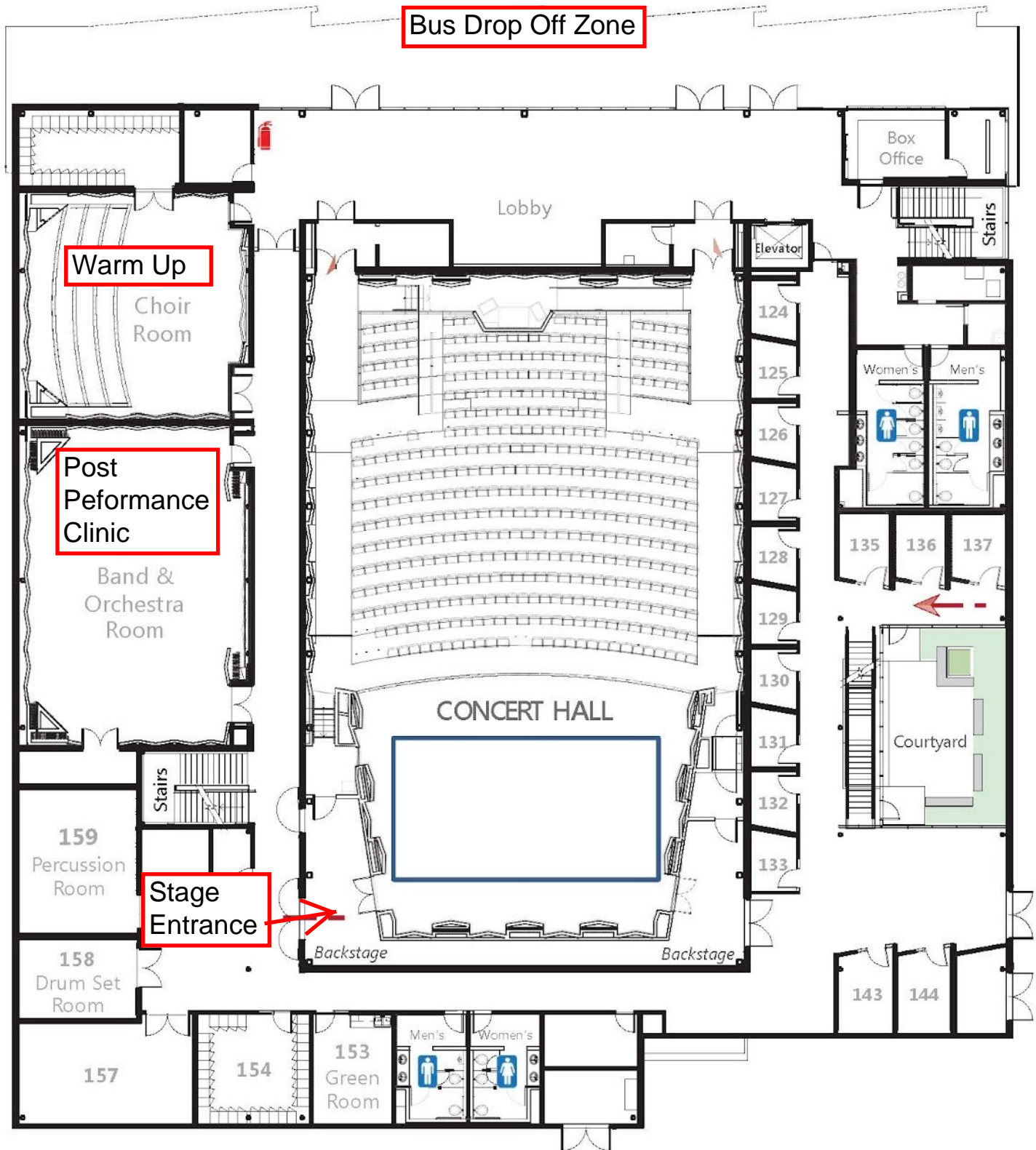



# HENRY W. COIL SR & ALICE EDNA COIL SCHOOL FOR THE ARTS

## 2nd Floor Map

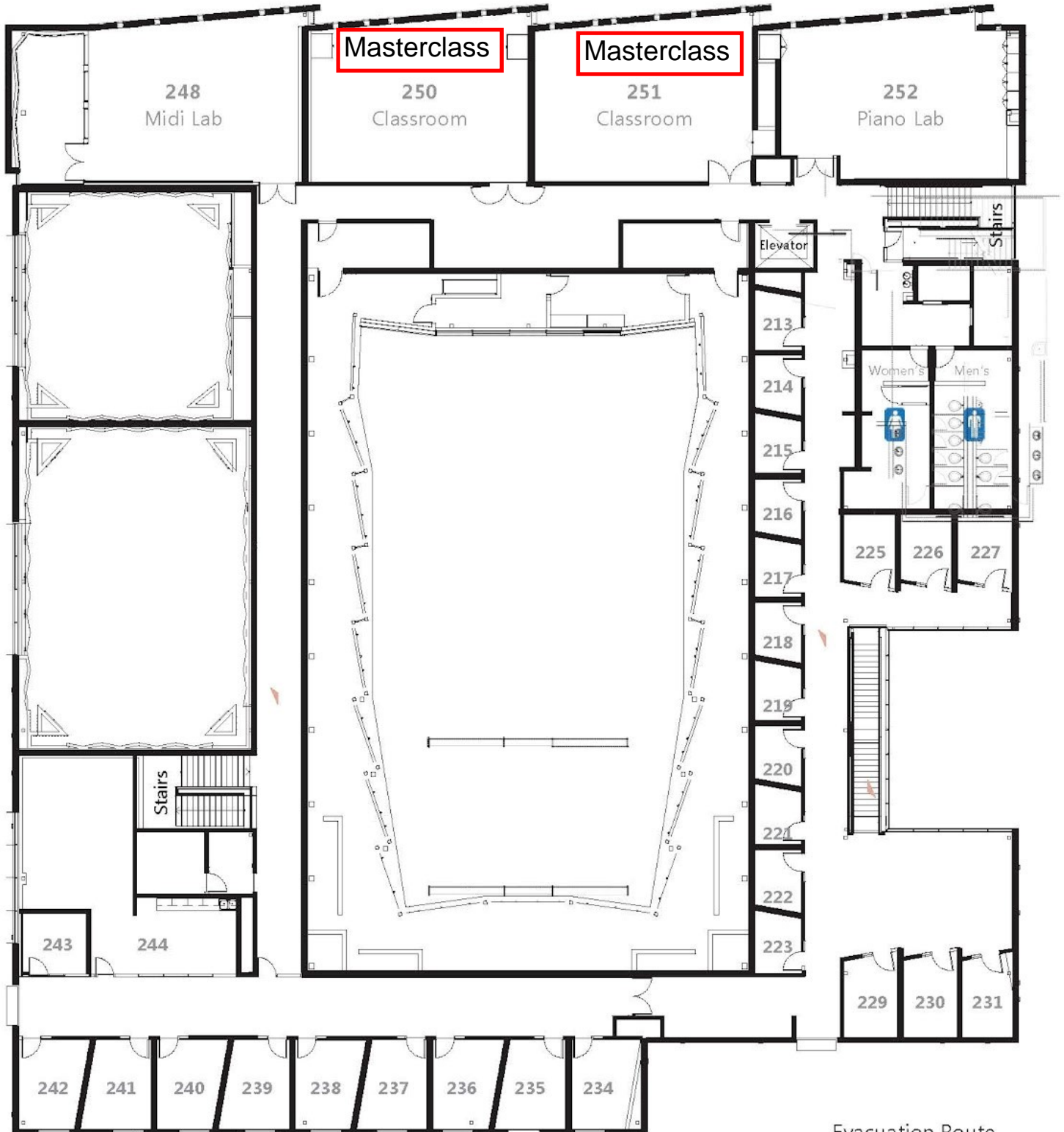

- Evacuation Route
- Fire Extinguisher
- Fire Alarm Pull Station



# Essentially Ellington Regional Festival

## Riverside City Collge, Saturday March 2nd

Personnel and Set List

SCHOOL			DIRECTOR		
ENSEMBLE NAME					
Saxophones			Trombones		
Alto 1			Lead		
Alto 2			2nd		
Tenor 1			3rd		
Tenor 2			4th		
Baritone			Bass		
Trumpets			Rhythm Section		
Lead			Piano		
2nd			Bass		
3rd			Guitar		
4th			Drums		
5th			Vibes/Aux		

<u>Selection 1</u>	
Title	
Comp/Arr	
Soloists	
<u>Selection 2</u>	
Title	
Comp/Arr	
Soloists	
<u>Selection 3</u>	
Title	
Comp/Arr	
Soloists	
<u>Selection 4</u>	
Title	
Comp/Arr	
Soloists	