

**Saturday, March 9, 2019**  
**2019 Valencia High School Show**  
**@ Valencia High School in Placentia, California**  
**Winter Guard Association of Southern California (WGASC)**

**ITINERARY**

<b>TIME</b>	<b>EVENT</b>
8:30 AM	Report
9:00 AM	Rehearsal Begins
12:00 PM	Rehearsal Ends
12:30 PM	Load Equipment / Get Ready / Eat Lunch
2:00 PM	Load Bus
2:15 PM	Depart from Trabuco Hills High School
3:00 PM	Arrive at Valencia High School Check-in / Restroom / Snack
4:15 PM	Line-up to depart for warm-up
4:30 PM	Warm-Up
5:35 PM	Depart from warm-up
6:07 PM	Ready Door
<b>6:17 PM</b>	<b>Performance</b>
6:25 PM	Fold Floor / Load
7:00 PM	Dinner Return to the gymnasium
8:56 PM	Awards
9:45 PM	Depart from Valencia High School
10:30 PM	Approximate Arrival at Trabuco Hills High School
10:35 PM	Unload Equipment and Clean-Up
11:00 PM	Approximate Dismissal

**\*\*\* Please keep in mind, no schedule is sacred and always subject to change!!!**



## DIRECTIONS FROM TRABUCO HILLS HIGH SCHOOL

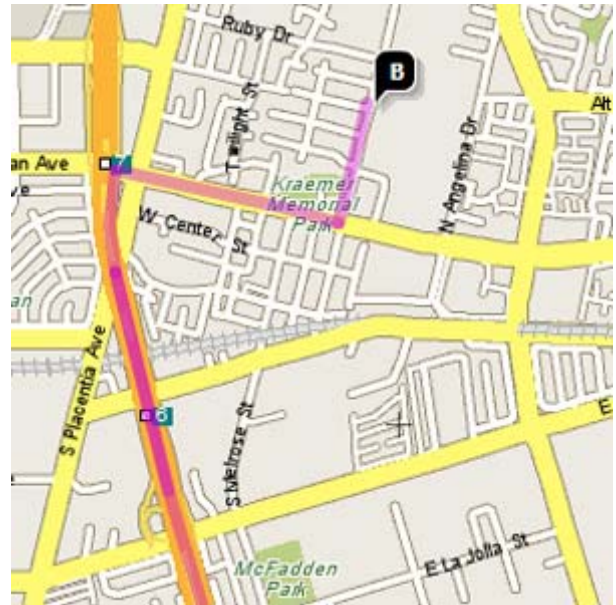
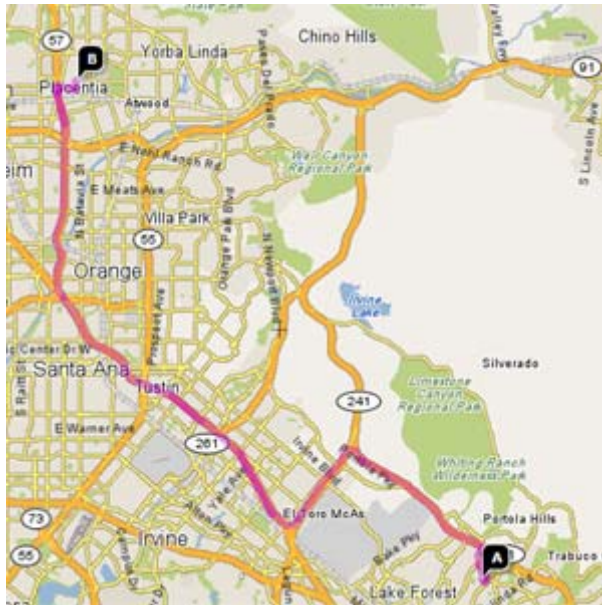

**Valencia High School**  
**500 North Bradford Avenue**  
**Placentia, California 92870**

Total Distance: 27.5 miles, Total Travel Time: 26 mins

- Take I-5 Freeway North
- Take SR-57 Freeway North
- Exit Chapman Avenue (Exit #6B) in Fullerton and turn right
- Turn left on Bradford Avenue
- Valencia High School will be on your right-hand side

**Saturday, March 9, 2019**  
**2019 Valencia High School Show**  
**@ Valencia High School in Placentia, California**  
**Winter Guard Association of Southern California (WGASC)**

**Performance Schedule (as of 03/04/19)**

<b>CLASS</b>	<b>SCHOOL</b>	<b>PERFORM</b>
JH AAA	Lone Hill Middle School	9:00 AM
JH AAA	Brea Junior High School	9:07 AM
JH AAA	Tuffree Middle School #1	9:14 AM
<b><i>BREAK</i></b>		<b><i>9:21 AM</i></b>
JH AA	Miller Middle School	9:28 AM
JH AA	Travis Ranch Middle School	9:35 AM
JH AA	Earhart Middle School	9:42 AM
<b><i>BREAK</i></b>		<b><i>9:49 AM</i></b>
JH A	Alvarado Intermediate School	9:56 AM
JH A	Lisa J. Mails Elementary School	10:03 AM
JH A	Townsend Junior High School	10:10 AM
JH A	Kraemer Middle School	10:17 AM
<b><i>BREAK</i></b>		<b><i>10:24 AM</i></b>
JH Open	McElhinney Middle School	10:38 AM
JH Open	Yorba Linda Middle School	10:45 AM
<b><i>BREAK</i></b>		<b><i>10:52 AM</i></b>
HS AA	Sonora High School	10:59 AM
HS AA	Northwood High School	11:06 AM
HS AA	Fullerton Union High School	11:13 AM
HS AA	Palisades Charter High School	11:20 AM
HS AA	Portola High School	11:27 AM
HS AA	Buena Park High School	11:34 AM
HS AA	West Covina High School #2	11:41 AM
<b>AWARDS</b>		<b>11:48 AM</b>



**Saturday, March 9, 2019**  
**2019 Valencia High School Show**  
**@ Valencia High School in Placentia, California**  
**Winter Guard Association of Southern California (WGASC)**

**Performance Schedule (as of 03/04/19)**

<b>CLASS</b>	<b>SCHOOL</b>	<b>PERFORM</b>
HS A - Round 1	Los Amigos High School	12:33 PM
HS A - Round 1	Baldwin Park High School	12:40 PM
HS A - Round 1	San Dimas High School	12:47 PM
HS A - Round 1	Tustin High School	12:54 PM
HS A - Round 1	Troy High School	1:01 PM
HS A - Round 1	El Modena High School	1:08 PM
HS A - Round 1	Brea Olinda High School (Varsity)	1:15 PM
HS A - Round 1	Marina High School	1:22 PM
<b>BREAK</b>		<b>1:29 PM</b>
HS A - Round 2	Santa Margarita Catholic High School	1:36 PM
HS A - Round 2	Etiwanda High School (Frosh/Soph)	1:43 PM
HS A - Round 2	Centennial High School (JV)	1:50 PM
HS A - Round 2	Tesoro High School	1:57 PM
HS A - Round 3	Arcadia High School A	2:04 PM
HS A - Round 2	Rancho Bernardo High School (JV)	2:11 PM
HS A - Round 2	Los Osos High School #1	2:18 PM
HS A - Round 2	La Habra High School	2:25 PM
<b>BREAK</b>		<b>2:32 PM</b>
SAAA - Round 1	West Covina High School	2:46 PM
SAAA - Round 1	Vista Murrieta High School (Frosh/Soph)	2:53 PM
SAAA - Round 1	Riverside King High School #1	3:00 PM
SAAA - Round 1	Saugus High School	3:07 PM
SAAA - Round 1	Costa Mesa High School	3:14 PM
<b>BREAK</b>		<b>3:21 PM</b>
SAAA - Round 2	Etiwanda High School (JV)	3:29 PM
SAAA - Round 2	Arlington High School	3:36 PM
SAAA - Round 2	Norco High School	3:43 PM
SAAA - Round 2	Irvine High School	3:50 PM
SAAA - Round 2	Glen A. Wilson High School	3:57 PM
SAAA - Round 2	Simi Valley High School	4:04 PM
SAAA - Round 2	El Dorado High School (JV)	4:11 PM
<b>BREAK</b>		<b>4:18 PM</b>
SAAA - Round 3	Yorba Linda High School	4:34 PM
SAAA - Round 3	Valencia High School (OC) (JV)	4:41 PM
SAAA - Round 3	Santa Monica High School	4:48 PM
SAAA - Round 3	Patriot High School	4:55 PM
SAAA - Round 3	Huntington Beach High School	5:02 PM
SAAA - Round 3	Westminster High School (JV)	5:09 PM
<b>AWARDS</b>		<b>5:16 PM</b>



**Saturday, March 9, 2019**  
**2019 Valencia High School Show**  
**@ Valencia High School in Placentia, California**  
**Winter Guard Association of Southern California (WGASC)**

**Performance Schedule (as of 03/04/19)**

<b>CLASS</b>	<b>SCHOOL</b>	<b>PERFORM</b>
SAA	Rancho Bernardo High School (Varsity)	6:01 PM
SAA	El Toro High School (Varsity)	6:09 PM
<b>SAA</b>	<b>Trabuco Hills High School (Varsity)</b>	<b>6:17 PM</b>
SAA	Santa Ana High School	6:25 PM
SAA	Riverside Poly High School	6:33 PM
SAA	Centennial High School (Varsity)	6:41 PM
SAA	Vista Murrieta High School (JV)	6:49 PM
SAA	Sunny Hills High School #1	6:57 PM
SAA	Workman High School	7:05 PM
<b>BREAK</b>		<b>7:13 PM</b>
SA	Westminster High School (Varsity)	7:21 PM
IA	Icon Winter Guard	7:29 PM
<b>BREAK</b>		<b>7:37 PM</b>
SO	Upland High School (Varsity)	7:45 PM
SO	Etiwanda High School (Varsity)	7:54 PM
SO	Valencia High School (OC)	8:03 PM
SO	Vista Murrieta High School (Varsity)	8:12 PM
SO	Rowland High School	8:21 PM
<b>BREAK</b>		<b>8:30 PM</b>
SW	El Dorado High School	8:46 PM
<b>AWARDS</b>		<b>8:56 PM</b>

*Individual Equipment*  
*Individual Movement*  
*Design Analysis*  
*General Effect 1*  
*General Effect 2*  
*Design Clinician*  
*Penalties*  
*Chief Judge*  
*Tech*  
*Announcer*  
*Contest Director*

*Amy Mack*  
*Katie Anderson*  
*Lorraine Kohagen*  
*Shirl Chumley*  
*Laura Baker*  
*Laura Baker*  
*Christopher Rutt*  
*Lorraine Kohagen*  
*Marina Furman*  
*Christine Brady*  
*Shalena Gonzales*





# WGASC Show @ Valencia (OC) - Gym Area Map

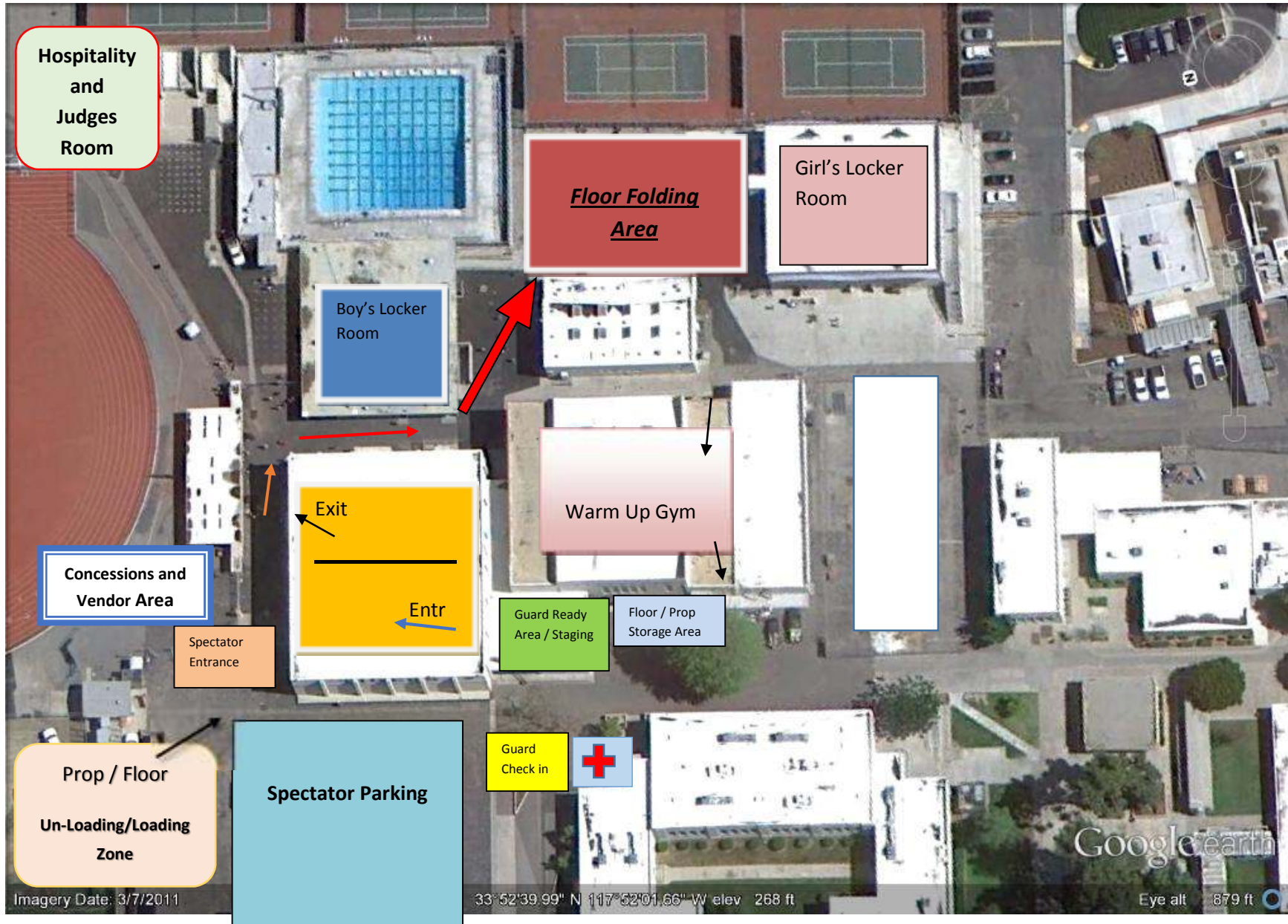

# WGASC Show @ Valencia HS (OC)

## Performance Gym Layout

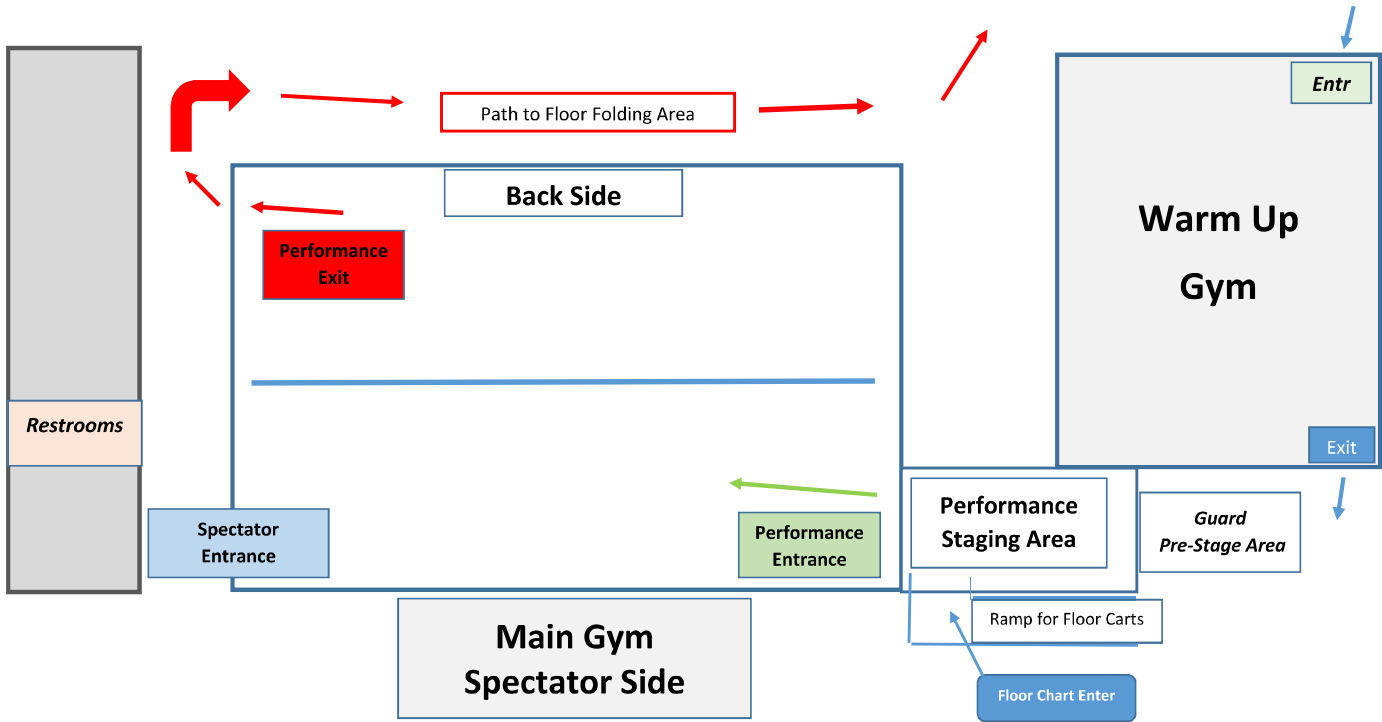

# WGASC Show @ Valencia HS (OC)

## "Rain Plan"

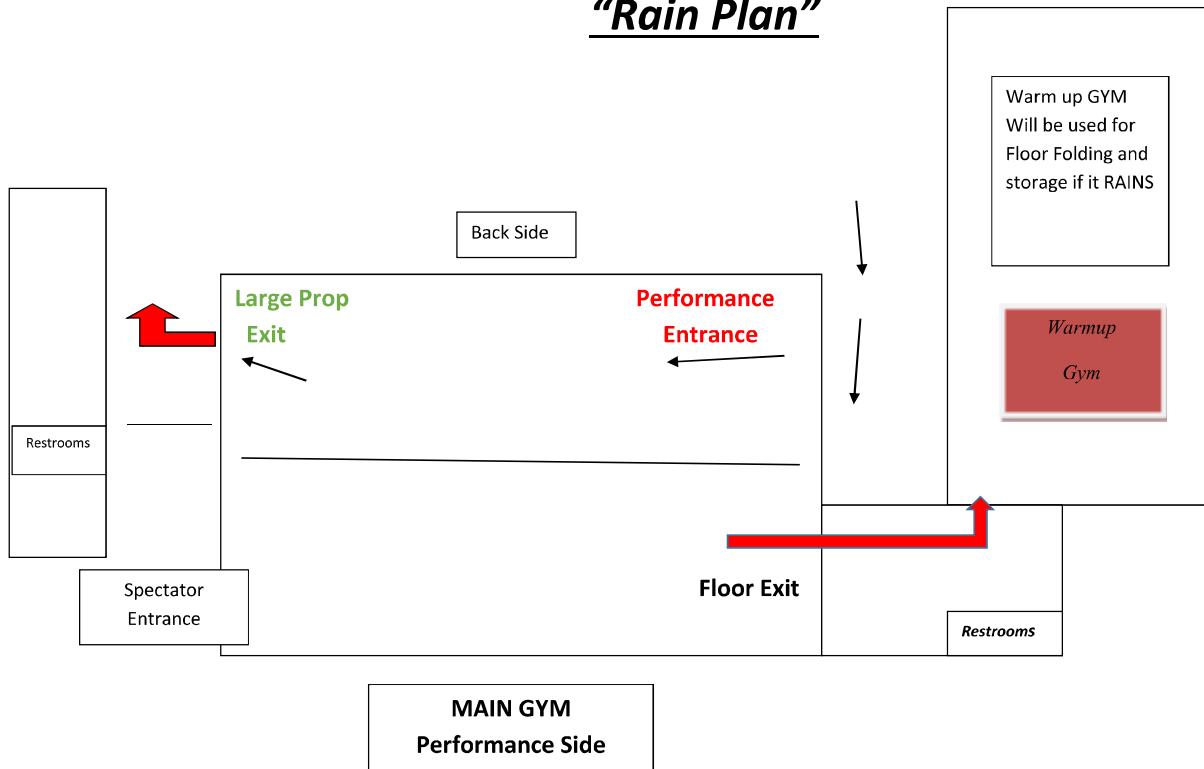





# Gym Specs.



**Stand to Stand = 71' 5"**

**Wall to Wall = 103' 9"**

**Judge's Side Stands = 15 Rows**

**Guard Seating = 15 Rows** *(11 Rows accessible during Show)*

## **Doors**

**Height = 7'**

**Width (Center Pin Removed) = 6' 6"**

**Approx. Seating Cap. = 750 each side**



**Judges / Audience View**

*(at top of stands)*

**Performers  
Point of View**

*Towards Judges Stands*



**Ceiling / Lights in  
Performance Gym**



## Performer Entrance

*(Front Right of Performance Floor)*



## Performer Exit

*(Back left of Performance Floor)*

## Floor Folding Area

*(Large enough to open floors all the way!!)*





**Warm - up Space**

*(In the middle of campus)*

**Warm - up Space**

*(Next to stadium / near Gym)*



**Warm - up Space**

*(Outdoor Courts behind Stadium)*



**Warm – up  
Gym**



**Performance  
Entrance Area**  
*(outside view)*

**Performance  
Entrance Ramp  
Area**  
*(Outside View)*





**Prop / Floor**  
(Unloading and  
Loading)  
**Zone**



**Concession / Eating**  
**Area**

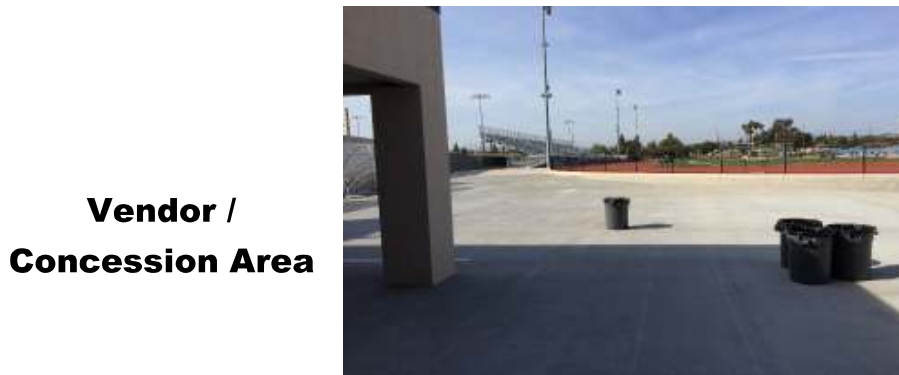

**Vendor /**  
**Concession Area**



# WGASC Show @ Valencia (OC) - Campus map #1





Guard  
Staging/ Entr  
Area

# Warm – Up Gym Layout

for the WGASCSHOW @ Valencia HS – OC

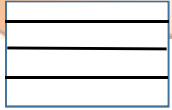

A Side

B Side



Exit Here

Spectator Stands

Enter Here

