



# ESSENTIALLY ELLINGTON

**Southern California Regional Festival**

**Riverside City College  
Coil School for the Arts**

**Friday, February 28<sup>th</sup> and Saturday, March 1<sup>st</sup>**

## **DIRECTOR'S PACKET**

**2<sup>nd</sup> Annual *Essentially Ellington* Regional High School Jazz Band Festival**

**presented in collaboration with**

**Southern California School Band and Orchestra Association  
RCC Coil School for the Arts**



## Welcome to the 2025 *Essentially Ellington* So Cal Regional High School Jazz Band Festival

We are very excited to present two days of festival performances, masterclasses, and guest artist concerts all provided to you and your students as a source of inspiration, education, and celebration of community.

On behalf of the Southern California School Band and Orchestra Association, I want to thank **Charlie Richard** and the entire staff here at **RCC's Coil School for the Arts** for their generosity in providing a truly outstanding venue for this festival. Another huge shout out goes to **Todd Stoll, Maegan Kelly, and everyone at Jazz at Lincoln Center** for your guidance and support in establishing what we all hope will grow into a staple of the Southern California Jazz Education scene.

Finally, *THANK YOU* to all the **directors, students, and parents** for participating this year! Without you, none of this is even possible. It is my mission to provide you with the best possible educational event that I can and I hope that this lives up to what I've envisioned for our community.

Here's to having two incredible days of music, learning, and fun!

A handwritten signature in black ink, appearing to read "Dennis Crystal".

Dennis Crystal  
VP, Jazz Education  
Southern California School Band and Orchestra Association



ESSENTIALLY  
ELLINGTON



## Festival Overview

### Location

Riverside City College, Coil School for the Arts  
3890 University Avenue  
Riverside, CA 92501

### Admission \$10 General Admission

Tickets will be sold at the door for all non-performers. Registered bands and their directors will all receive passes for the day.

### Friday, 2/28

8:00am – 11:30am	Festival High School Performances	Coil Hall Stage
12:00pm	RCC Jazz Ensemble Concert Directed by James Rocillo	Coil Hall Stage
1:00pm	Masterclass Sessions Scott Brown - Band Directors Masterclass John Beasley – Rhythm Section Masterclass Pharez Whitted – Brass Masterclass Charlie Richard – Saxophone Masterclass Matt Johnson – Drumset Masterclass	Classroom CSU 250 Coil Hall Stage Choral Hall Classroom CSA 251 Rickson Band Hall
2:30pm – 6:30pm	Festival High School Performances	Coil Hall Stage
7:30pm	RCC Jazz Orchestra Concert Directed by Charlie Richard	Coil Hall Stage

### Saturday, 3/2

8:00am – 11:30am	Festival High School Performances	Coil Hall Stage
12:00pm	CSU Long Beach Concert Jazz Orchestra Directed by Jeff Jarvis	Coil Hall Stage
1:00pm	Masterclass Sessions Scott Brown - Band Directors Masterclass John Beasley – Rhythm Section Masterclass Pharez Whitted – Brass Masterclass Charlie Richard – Saxophone Masterclass Aarón Serfaty – Drumset Masterclass	Classroom CSU 250 Coil Hall Stage Choral Hall Classroom CSA 251 Rickson Band Hall
2:30pm – 6:30pm	Festival High School Performances	Coil Hall Stage
7:30pm	RCC Jazz Orchestra Concert Directed by Charlie Richard	Coil Hall Stage



ESSENTIALLY  
ELLINGTON



# Director Festival General Information

## Equipment

The following gear will be provided in the warm-up, performance, and clinic rooms:

Piano  
Bass Amp  
Vibes  
Drumset w/ 2 cymbal stands (no cymbals) and hi-hat WITH cymbals.

Please bring your own guitar amp *as well as hi-hat stand with hi-hats if you want to use your own.* In order to prevent any potential delays of the festival caused by the inevitable missing clutch, you will not be able to change the hi hat cymbals on the provided gear in any room, although they will be good quality cymbals that you are welcome to use. If you want to use your own hi-hats, you need to bring the stand too.

**Bass Players** must have their own instrument and cable.

**Guitar Players** must have their own instrument and cable.

### Instrument Cases Storage

We will have designated instrument/case storage areas upstairs for bands to use during the day. Space is tight up there, so you are also encouraged to use the storage on your busses once you're done playing for the day. There is a bus loading zone outside the front of the Coil School, so loading should be very quick and easy for you.

### Copies of Music Scores

Music scores are **NOT** required to be turned in. If you want to submit 2 copies to the judges, that's fine, but it's not required.

### Sound

The acoustics of the Coil Hall are remarkable and we want every band to sound their best. We will provide a professional engineer to run sound for the day. Here are some thoughts to consider about our approach to sound reinforcement for this festival that I am borrowing from the UNLV Regional:

*We all know that over-amplified big bands are simply not appropriate for the genre, and most of you have probably experienced a well-balanced big band being ruined by overzealous sound personnel with too many microphones. For this reason, our philosophy is to allow the performance to be as purely acoustic as possible, allowing the true balance of your band to be heard by the audience and judges. The only sound amplification that will be used for your performance will be for soloists, and possibly a small amount of piano and upright bass to*



ESSENTIALLY  
ELLINGTON



*ensure a good balance with the band if needed. You will see several solo microphones in each section, 3 for saxophones, 2 for trombones, and 2 for trumpets. These mics will remain off until needed for a solo. There will also be two “front” mics downstage – one is typically used for speaking and the other one is for soloists that have time to go down front (we love seeing soloists come down front – but it isn’t required).*

*For each song you play, please instruct your soloists to ensure the nearest solo microphone in their section is placed so that the microphone is approximately 8"-18" away from the bell of the horn (or slightly to the player’s right of the bell for saxophones), and if possible, each soloist should stand up to ensure we have the solo mic turned up and ready as soon as they play their first note. We will also be on the lookout for doubles (flutes, clarinets, etc.) and will ensure they are heard assuming the mic is placed correctly.*

*Your oversight here will help us ensure a great sounding concert for your band. We are committed to doing our very best to ensure an accurate sound is what is heard by the audience. Less is more!*

### **Judging Format**

The format of this festival is non-competitive with written and recorded feedback coming from two of our clinicians. These score sheets and audio commentary will be available shortly after your performance. You can pick up your sheets in the lobby from our festival coordinators and your commentary will be emailed to you.

There will also be two additional clinicians listening to your performance in the hall that will give you a feedback clinic afterwards. These clinicians will not do written or recorded comments, but will work directly with your band when your performance is over.

### **Awards**

*Essentially Ellington* is a non-competitive festival. There will be no placements or rankings of the bands at any point during the day. Any awards recognizing some of the exemplary performances (individuals and sections) that the judges heard during the day will be included in your packet with your score sheets.

### **Food Service For Your Students**

The schedule for the day is full so that we can get every band in that wants to participate. Each band director will have the latitude to arrange for getting their students fed. The RCC Music Students will provide pizza and waters for sale in front of the Coil School or, you can take your group to one of the nearby restaurants in the Downtown Riverside area. The Food Lab is just a couple of blocks away and has a variety of options.



ESSENTIALLY  
ELLINGTON



### Attendance to All Events

We encourage directors and students to participate in all activities during the day at the festival, including the masterclasses and the featured concerts so that everyone can maximize this wonderful educational experience celebrating our American music. We look forward to sharing this unforgettable and collaborative educational experience with you and your dedicated students. It will provide a lasting impact and create a culture of fellowship with performances, master classes and concerts for all who participate in this unique festival that honors our great Jazz legacy!

### Essentially Ellington Festival Requirements

1. All bands participating in the *EE* Festival must join Jazz at Lincoln Center's 2024-2025 *Essentially Ellington* High School Jazz Band Program (*EE*). By joining the free program, schools receive original transcriptions or arrangements by Duke Ellington and other seminal big band composers and arrangers, as well as recordings, rehearsal videos, teaching guides, and other resources. <http://academy.jazz.org/ee/>
2. All bands participating in the *EE* Festival must be comprised of high school students. High school bands will each perform a 20-minute set (30 total minutes on stage). All bands participating in the *EE* Festival must perform at least one selection from Jazz at Lincoln Center's *Essentially Ellington* print music series. In addition to the 2024-2025 charts received through their membership with *Essentially Ellington*, bands may also elect to perform any of the previously published charts in the *EE* library.

### Essentially Ellington Regional Festival Performance Details

1. Each band will be given access to a warmup room for 25 minutes before their performance.
2. Each band will be given 5 minutes for stage set-up, 20 minutes for performance, and 5 minutes to exit the stage.
3. The warmup room, stage, and clinic room are all very close to one another, so it will be very easy and self-evident where to go. However, we will have RCC students to help you in every space and direct you to the next area or provide any other support you might need.

Warmup Room	Choral Rehearsal Room
Performance	Coil School for the Arts Concert Hall
Clinic	Rickson Band Hall



ESSENTIALLY  
ELLINGTON



## Getting Here

**RCC Coil School for the Arts**  
**3890 University Avenue**  
**Riverside, CA 92501**

**Bus Parking:** There is a bus loading zone immediately in front of the building. Buses should drop you drop off with all of your equipment in front of the Coil School. Buses will then park in Lot U at the RCC Main Campus (see the attached map) at the corner of Ramona and Olivewood. It's not far from the Coil School, so if you need your busses to come back to load, it won't take long.

**Festival Attendee Parking:** There is a parking structure next to the Coil School that attendees are free to use. Just be aware that parking is NOT FREE on Friday, since it's a school day. Anybody parking in that structure will have to purchase a permit for the day to park there. On Saturday, parking is free in the Coil School Parking Structure.

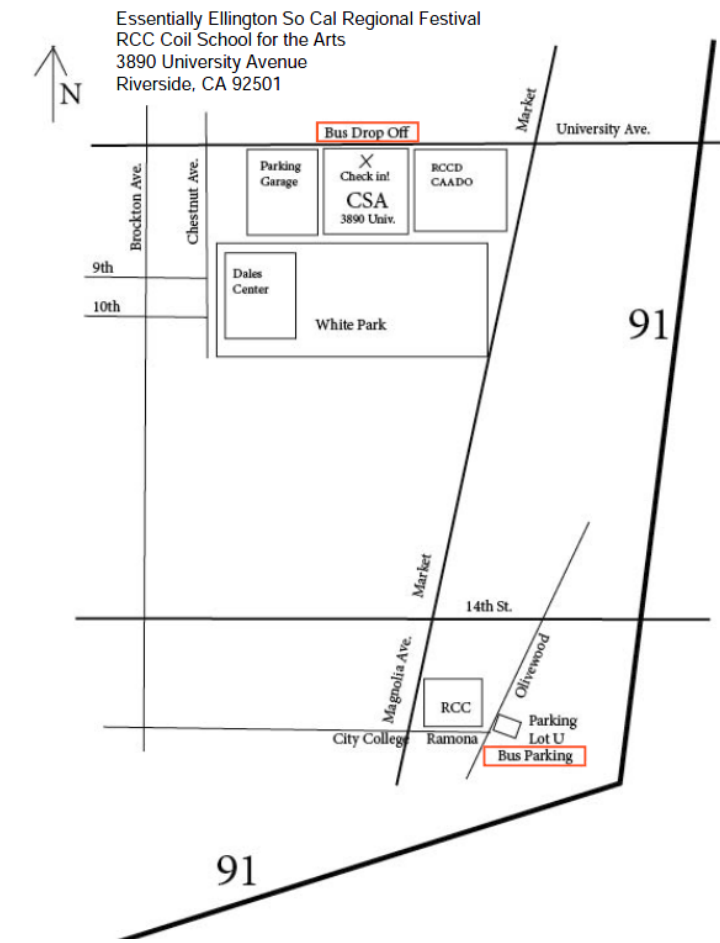



ESSENTIALLY  
ELLINGTON



RCC  
RIVERSIDE CITY COLLEGE

## Meet Our Guest Adjudicators and Clinicians



### **John Beasley**

John Beasley is a versatile pianist who backed Miles Davis and Freddie Hubbard in his 20s. Since then, he has performed with Dianne Reeves, Christian McBride, Chaka Khan, Kenny Garrett. His 20+ recordings have earned him 2 GRAMMY® Awards, 12 nominations, and 2 Latin Grammy nominations.

In 2017, Beasley formed a big band, MONK'estra, which released three albums. He became an in-demand arranger/conductor for European jazz orchestras, including Germany's HR and SWR BB, Sweden's Blue House and Bohuslän BB, along with bands from Belgium to Russia.



### **Pharez Whitted**

Pharez Whitted is a performer, educator, composer, producer, clinician, and was nominated for Independent Jazz Artist of the Year in 2011. Pharez has performed throughout the United States and overseas, including performances at Presidential Inaugurations, The Arsenio Hall Show, The Billboard Music Awards, Carnegie Hall, and major jazz festivals throughout the country to name a few. Whitted studied music at DePauw University and went on to earn a master's degree from the Indiana University Jacobs School of Music. He has taught at prestigious colleges and universities such as Wabash College, The Ohio State University, Chicago State University and most recently at Northern Illinois University. He is also the Director of the Chicago Youth Symphony Orchestra's (CYSO) Jazz Orchestra.



### **Scott Brown**

Scott is a graduate of the University of Washington. He is the recently retired, 38-year, nationally recognized Director of Bands at Seattle's Roosevelt High School. Scott is the recipient of many awards for his teaching, including the Downbeat Magazine Outstanding Jazz Educator, a 2022 inductee to the Washington Music Education Association Hall of Fame, and the Washington State Golden Apple Award for excellence in education. Scott has been a faculty member for Jazz at Lincoln Center's Band Director Academy and serves as an adjudicator for their Essentially Ellington regional competitions.





ESSENTIALLY  
ELLINGTON



## Matt Johnson

Drummer, author and music educator Matt Johnson, lauded as “a hurricane on sticks!” (the *Los Angeles Times*) is equally versed in all forms of jazz, pop and world drumming styles and has performed with a range of entertainers, from singers Julie Andrews and Andy Williams and Surf-rock pioneers Jan and Dean to big band legends Billy May and Les Brown. He is a founding member of the Tony Guerrero Quintet which, since 2014, has toured with Golden Globe- and Emmy Award-winning actress/comedienne Jane Lynch (*Glee*, *The 40-Year-Old Virgin*, *Hollywood Game Night*, *The Weakest Link*).

Along with his busy performance schedule, Johnson currently serves on the music faculty at Fullerton College and the Idyllwild Arts Academy. He currently puts his years of performance experience to work as an in-demand guest artist/clinician and adjudicator at high school and college jazz festivals as well as performing as Master of Ceremonies for Forum Music Festivals.



## David Caffey

David Caffey is an internationally recognized composer, arranger, conductor, and educator. His most recent CD, *At The Edge of Spring*, by the David Caffey Jazz Orchestra, was recently released in January 2025. The DCJO has two earlier CD releases, *All In One* (2018) and *Enter Autumn* (2015). His compositions and arrangements have also appeared on CD albums released by The Jeff Benedict Big Band (Holmes), Dekajaz (Eclectikos), UNC Jazz Lab Band I (The Romeo & Juliet Project, Journey Home, Alive VII, IX, XI, and XVIII) and many other university CDs and LPs.

David Caffey is Professor Emeritus of Music at the University of Northern Colorado, where he served as Director of the School of Music from 2005 to 2013. His work as a college music professor and arts administrator spans 44 years and includes previous appointments at California State University - Los Angeles, Sam Houston State University, the University of Denver Lamont School of Music, Southern Oregon University, and Cal Poly University - Pomona. He served as Associate Dean of the College of Letters, Arts and Social Sciences at Cal Poly Pomona. He currently resides in Southern California, in the Los Angeles area.



## Aarón Serfaty

Aarón Serfaty was born in Caracas, Venezuela. He began playing the drum set at the age of 15 and started to play professionally at 17. He did extensive work as a session and touring drummer from 1980 until 1991 with local and international artists. In 1991, he moved to Los Angeles to study Jazz and African American Studies at the California Institute of the Arts (Albert “Tootie” Heath, Joe LaBarbera). He has also studied with Peter Erskine, Jeff Hamilton, Jerry Steinholz, and Juan Oliva.

Aarón has played with Arturo Sandoval, Sergio Mendes, Jon Anderson, Dori Caymmi, and Don Grusin among many others. He has done clinics and master classes at the Lima Jazz Festival in Peru in 2006, the First Latin American Drummers Festival in



ESSENTIALLY  
ELLINGTON



Caracas, Venezuela in 2004 and at the French Polynesia Conservatory of Music in Papeete, Tahiti in 2005. Aarón Serfaty is currently on faculty at the University of Southern California (1997-present), The California Institute of the Arts (2000-present), and the Los Angeles Music Academy (1996-present).

## About *Essentially Ellington*

The *Essentially Ellington* High School Jazz Band Program (*EE*) is unique among educational resources for high school jazz bands. Each year, Jazz at Lincoln Center transcribes, publishes, and distributes charts by Duke Ellington and other seminal big band composers and arrangers, along with additional educational materials to bands across the globe. Beyond providing these charts, *Essentially Ellington* also supports its members throughout the school year with a variety of initiatives including teaching guides, the *Essentially Ellington* website, newsletters, a student composition contest, and professional feedback of student performances of the charts.

Schools that join the program are eligible for participation in non-competitive regional festivals and have the option to submit a recording for the national *Essentially Ellington* High School Jazz Band Competition & Festival held annually in New York City at Frederick P. Rose Hall, the home of Jazz at Lincoln Center. Fifteen bands are selected as finalists and, to prepare, each finalist band receives an in-school workshop in their community led by a professional musician. The Competition & Festival culminates in a three-day festival in May for the finalist bands, including workshops, rehearsals, jam sessions, and performances. The three top-placing bands perform an evening concert with the Jazz at Lincoln Center Orchestra.

We look forward to sharing this unforgettable and collaborative educational experience with you and your dedicated students. It will provide a lasting impact and create a culture of fellowship with performances, masterclasses and concerts for all who participate in this unique festival that honors our great Jazz legacy!

<b>Friday, February 28th</b>		
<b>Time</b>	<b>Ensemble</b>	<b>Clinicians</b>
8:30 AM	Santiago HS Jazz III	Johnson/Brown
9:00 AM	Oxford Academy Jazz Band	Whitted/Beasley
9:30 AM	Alta Loma HS Jazz II	Johnson/Brown
10:00 AM	Los Osos HS Studio Jazz Ensemble	Whitted/Beasley
10:30 AM	Santiago HS Jazz II	Johnson/Brown
11:00 AM	Cathedral City HS Royal Jazz Band	Whitted/Beasley
11:30 AM	<b>Lunch Break</b>	
12:00 PM	<b>RCC Jazz Ensemble</b>	
1:00 PM	<b>Masterclasses/Director Workshop</b>	
2:30 PM	Yorba Linda HS	Johnson/Brown
3:00 PM	Ventura HS Jazz A	Whitted/Beasley
3:30 PM	Alta Loma HS Jazz I	Johnson/Brown
4:00 PM	Newbury Park HS Jazz Ensemble	Whitted/Beasley
4:30 PM	<b>Judges Break</b>	
5:00 PM	Thousand Oaks HS Studio Jazz Ensemble	Johnson/Brown
5:30 PM	Herbert Hoover Jazz	Whitted/Beasley
6:00 PM	Calabasas Jazz A Band	Johnson/Brown
6:30 PM	Westlake HS Studio Jazz Ensemble	Whitted/Beasley
7:00 PM	<b>RCC Jazz Orchestra</b>	

<b>Saturday, March 1st</b>		
<b>Time</b>	<b>Ensemble</b>	<b>Clinicians</b>
8:30 AM	Aliso Niguel HS	Whitted/Beasley
9:00 AM	Orange HS Jazz Band	Johnson/Brown
9:30 AM	Trabuco Hills HS	Whitted/Beasley
10:00 AM	Esperanza HS Jazz III	Johnson/Brown
10:30 AM	OCSA Jazz Ensemble	Whitted/Beasley
11:00 AM	El Camino Real Studio Jazz Ensemble	Whitted/Beasley
11:30 AM	<b>Lunch Break</b>	
12:00 PM	<b>Cal State Long Beach Concert Jazz Orchestra</b>	
1:00 PM	<b>Masterclasses/Director Workshop</b>	
2:30 PM	El Toro HS	Johnson/Brown
3:00 PM	Esperanza HS Jazz II	Whitted/Beasley
3:30 PM	OCSA Studio Big Band	Johnson/Brown
4:00 PM	El Dorado Jazz II	Whitted/Beasley
4:30 PM	<b>Judges Break</b>	
5:00 PM	Santiago HS Jazz I	Whitted/Beasley
5:30 PM	OCSA Ambassador Jazz Orchestra	Johnson/Brown
6:00 PM	El Dorado Jazz I	Whitted/Beasley
6:30 PM	Esperanza HS Jazz I	Johnson/Brown
7:00 PM	<b>RCC Jazz Orchestra</b>	



**ESSENTIALLY  
ELLINGTON**

**So Cal Regional Festival**

February 28 - March 1, 2025  
Riverside City College

<b>Masterclass Schedule 1:00-1:50</b>		
John Beasley	Rhythm Section Masterclass	Rickson Band Hall
Pharez Whitted	Brass Masterclass	Choral Hall
Scott Brown	Band Director's Workshop	Classroom, CSA 250
Charlie Richard	Saxophone Masterclass	Classroom, CSA 251
Matt Johson	Drumset Masterclass	Coil Theater

<b>Masterclass Schedule 1:00-1:50</b>		
John Beasley	Rhythm Section Masterclass	Rickson Band Hall
Pharez Whitted	Brass Masterclass	Choral Hall
Scott Brown	Band Director's Workshop	Classroom, CSA 250
Charlie Richard	Saxophone Masterclass	Classroom, CSA 251
Aarón Serfaty	Drumset Masterclass	Coil Theater

Essentially Ellington So Cal Regional Festival  
RCC Coil School for the Arts  
3890 University Avenue  
Riverside, CA 92501

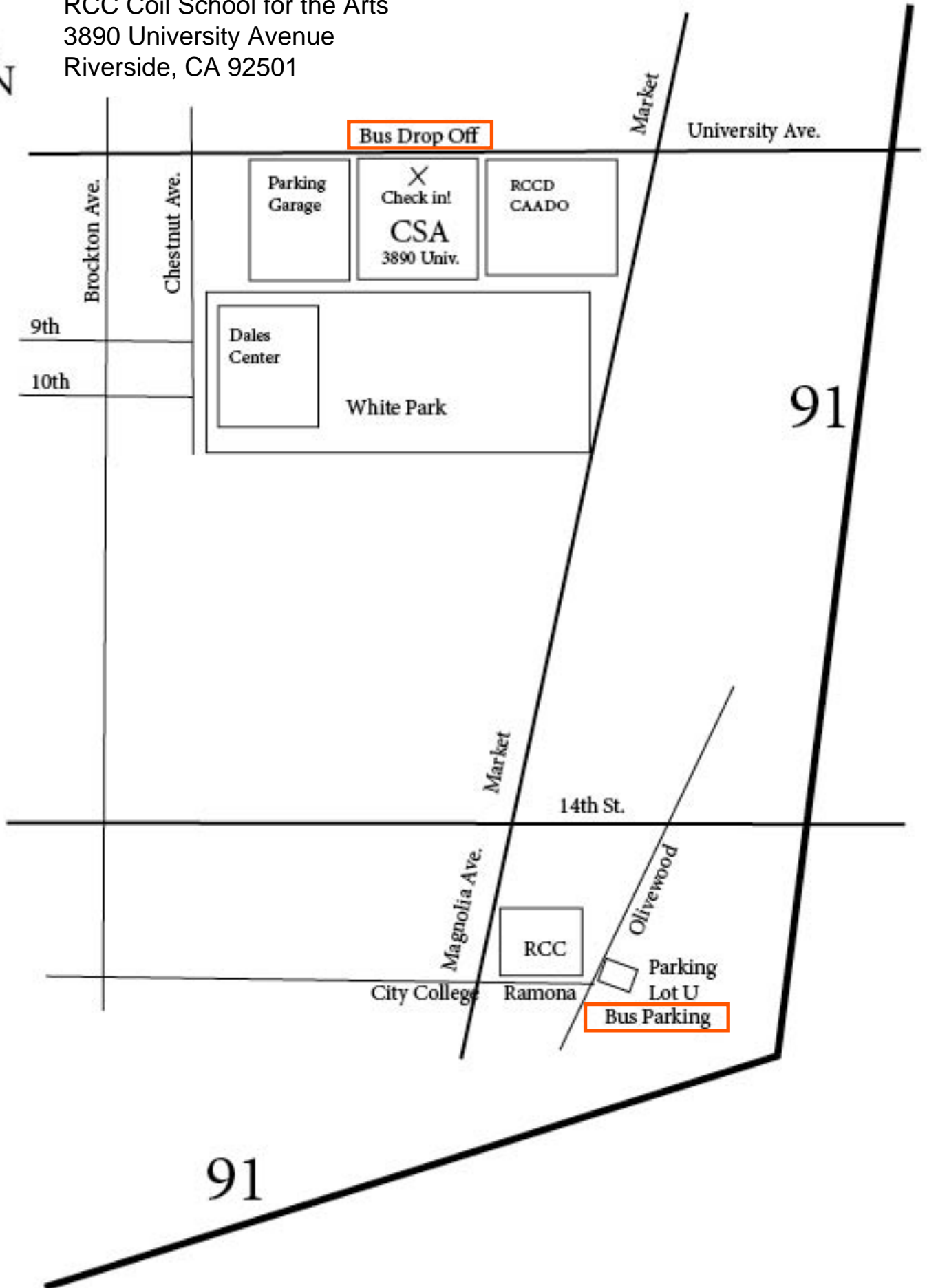

# 2024 Essentially Ellington So Cal Regional Festival Bus Parking in RCC Main Campus - Lot U Southeast Corner of Campus City College Drive and Olivewood Ave.

- Restrooms
- Accessible Restrooms
- ◆ Elevators
- ▨ Accessible
- 🚌 RTA Bus Lines
- 🚲 Bike Racks
- \$ Pay Parking
- ☎ Emergency Telephones
- Free Speech Area
- Healing Garden

- UPPER CAMPUS**
1. Digital Library & Learning Resource Center
  - Academic Senate/CTA
  - Auditorium
  - Glenn Hunt Center for Teaching Excellence
  - Instructional Media Center
  2. Administration (O.W. Noble)
  - Section A
    - Board Room
    - Disabled Services
    - H.O.M.E. Room (The Ujima Project)
    - Learning Disabilities Center
    - Mailroom/Admin Service Center
    - Veterans' Resource Center
    - Veterans' Services
  - Section B
    - Academic Affairs
    - Athletics
    - Business Services
    - Community Learning in Partnership (CLIP)
    - President's Office
    - Workforce Resource and Development
  3. Quadrangle (Arthur G. Paul)
  - Art Gallery
  - Community for Academic Progress (CAP)
  4. Business Education (Alan D. Pauw)
  - CalWORKS/Resource Center
  - Independent Living Program (ILP)
  - Micro Support Services
  - Workforce Preparation (WFP)
  5. Music
  - 5A. Music Annex
  6. Music Hall (Richard M. Stover)
  7. Landis Performing Arts Center
  - 7A. Landis Annex
  8. Martin Luther King, Jr. High Tech Center
  - Academic Labs
  - Center for Communication Excellence
  - Stem Center
  - Tutorial Services
  9. Assessment Center
  - Viewpoints
  10. Planetarium (Robert T. Dixon)
  11. School of Nursing
  - Healing Garden
  12. Math and Science Building
  13. Student Center (Ralph H. Bradshaw)
  - Aguilar Patio
  - Auxiliary Business Services/Cashier
  - Bookstore
  - Cafeteria/Food Services
  - Citrus Room
  - Extended Opportunities Programs & Services (E.O.P.S.)
  - Hall of Fame
  - Health Services
  - Heritage Room
  - Matriculation
  - Student Services/Student Activities
  - TRIO
  - Upward Bound
  - 13A. ASRCC Student Government
  - 13B. Information Services Telecom Annex
  14. Student Financial Services
  - Financial Aid
  - Network Services
  - Outreach Completion Counts Welcome Center
  - Student Employment Services
  15. Admissions & Counseling (Cesar E. Chavez)
  - Admissions & Records
  - Career/Transfer
  - Counseling
  - Transcripts
  - 15A. Annex/Wells Fargo
- LOWER CAMPUS**
16. Sports Complex (Samuel C. Evans)
  - Baseball Field
  - Pony League Field (Nate DeFrancisco)
  - Softball Field (Ab Brown)
  17. Early Childhood Studies
  18. Ceramics
  19. Art
  20. Gymnasium (Arthur N. Wheelock)
  - Athletics/Coaches' Office
  - Fitness Room
  21. Stadium (Arthur N. Wheelock Field)
  - Weight Room
  22. Nature Trail (Ariene & Robert F. Richard)
  23. North Hall
  - Finance & Accounting Services
  - Purchasing & Accounts Payable
  24. College House
  - Administration & Finance
  - Risk Management
  25. Riverside Aquatics Complex
  26. Technology B
  - Information Services
  - International Students Center
  - Printing & Graphics Center
  27. Technology A
  - Air Conditioning & Refrigeration
  - Career/Technical Education
  - Welding
  28. Automotive Technology
  - Lovekin Complex
  - College Safety and Police
  - Gateway to College (GTC)
  - Marching Tigers
  - Photo Lab & Studio
  - Tennis
  - Tennis Courts (Fran Bushman)
  30. Gymnasium (Catherine S. Huntley)
  - Band
  - Dance
  31. Pilates Studio (Eleanor H. Crabtree)
  32. Warehouse
  33. Maintenance & Operations
  34. Cosmetology
  35. Alumni House - 3564 Ramona Drive
  - Foundation
  36. Parking Structure
  37. Practice Field

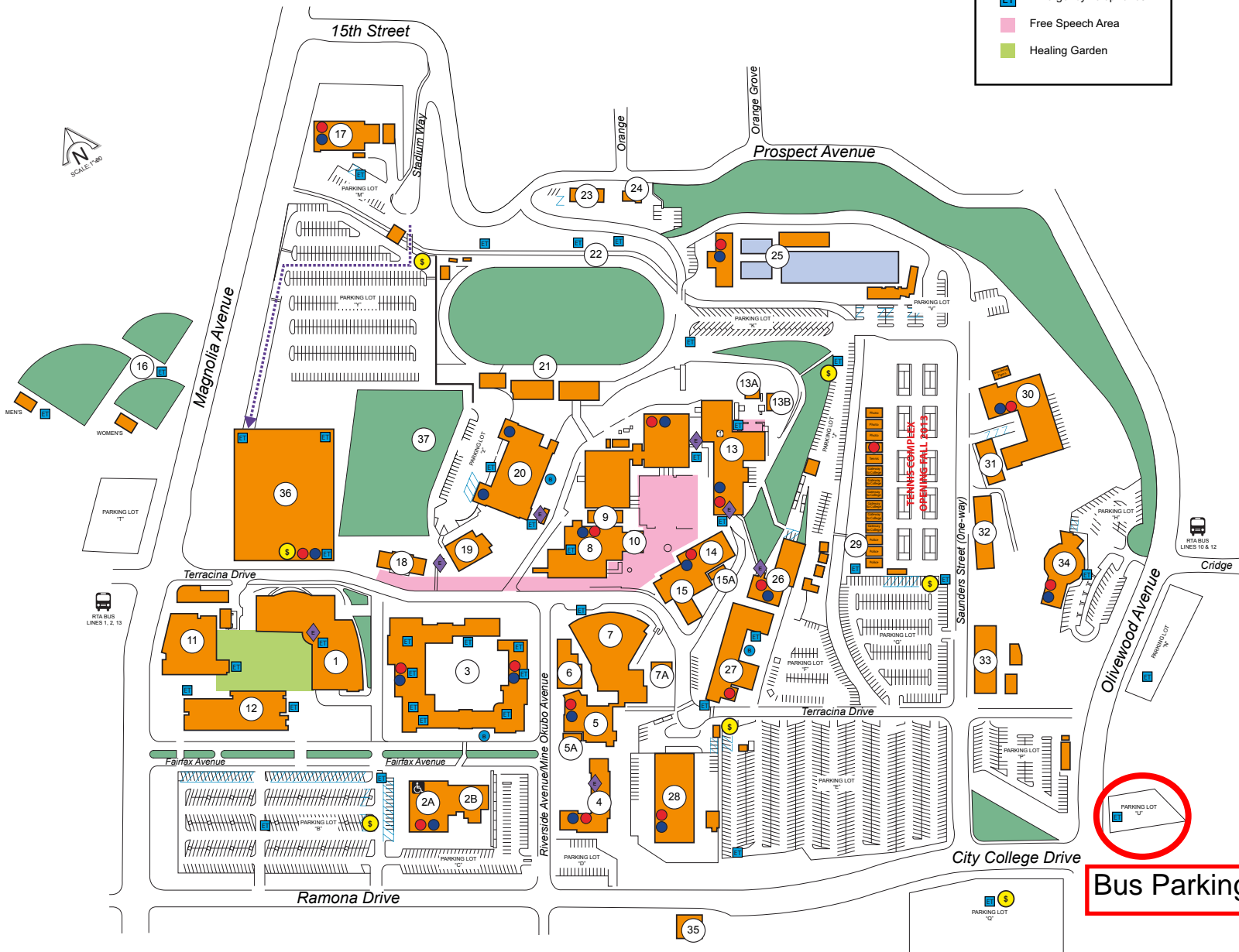

**Bus Parking**

# HENRY W. COIL SR & ALICE EDNA COIL SCHOOL FOR THE ARTS

## 1st Floor map

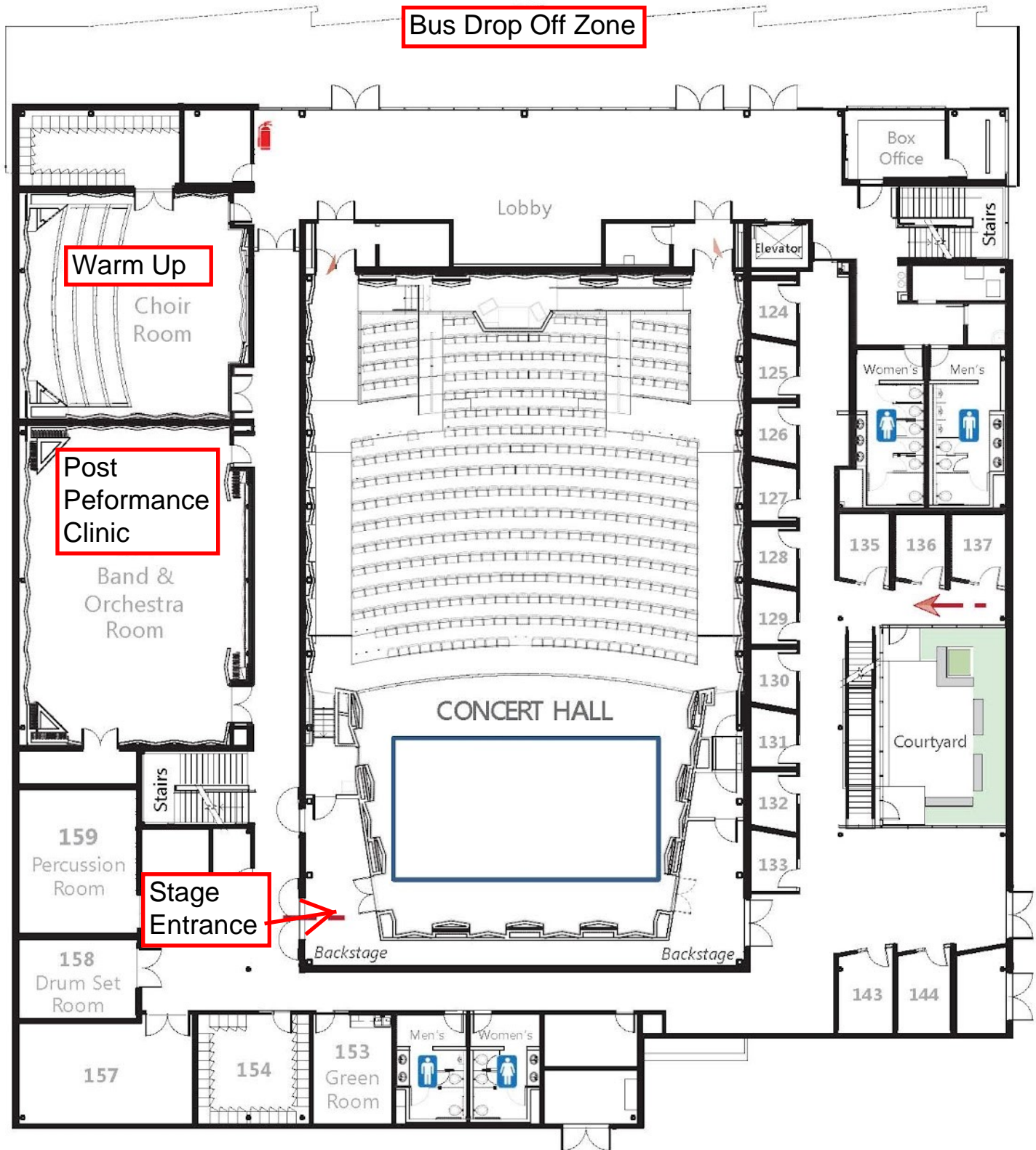

# HENRY W. COIL SR & ALICE EDNA COIL SCHOOL FOR THE ARTS

## 2nd Floor Map

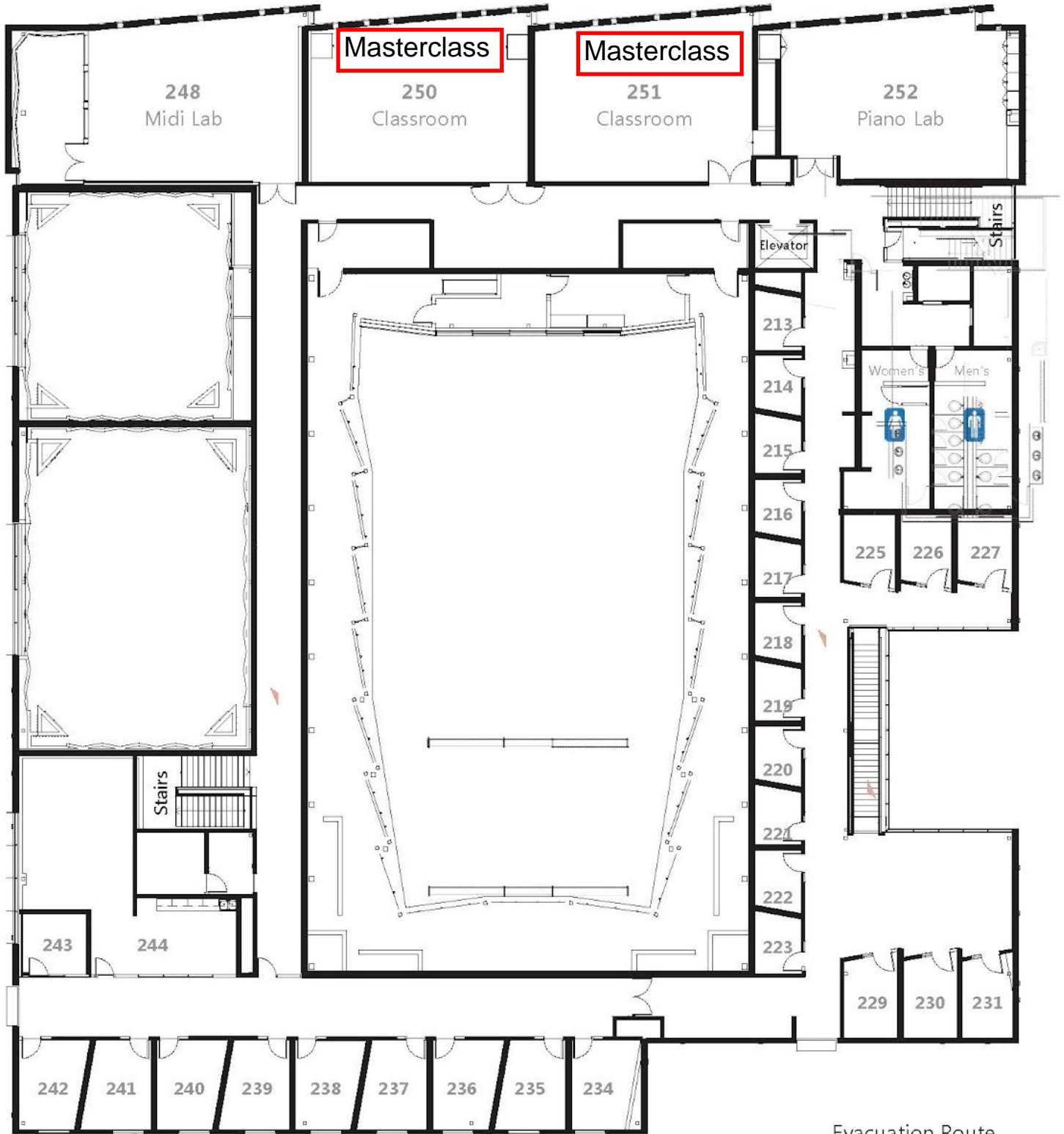

Evacuation Route  
Fire Extinguisher  
Fire Alarm Pull Station



# Essentially Ellington Regional Festival

## Riverside City Collge, Saturday March 2nd

### Personnel and Set List

SCHOOL			DIRECTOR		
ENSEMBLE NAME					
Saxophones			Trombones		
Alto 1			Lead		
Alto 2			2nd		
Tenor 1			3rd		
Tenor 2			4th		
Baritone			Bass		
Trumpets			Rhythm Section		
Lead			Piano		
2nd			Bass		
3rd			Guitar		
4th			Drums		
5th			Vibes/Aux		

<u>Selection 1</u>	
Title	
Comp/Arr	
Soloists	
<u>Selection 2</u>	
Title	
Comp/Arr	
Soloists	
<u>Selection 3</u>	
Title	
Comp/Arr	
Soloists	
<u>Selection 4</u>	
Title	
Comp/Arr	
Soloists	